

# VibraTag Charging Instructions

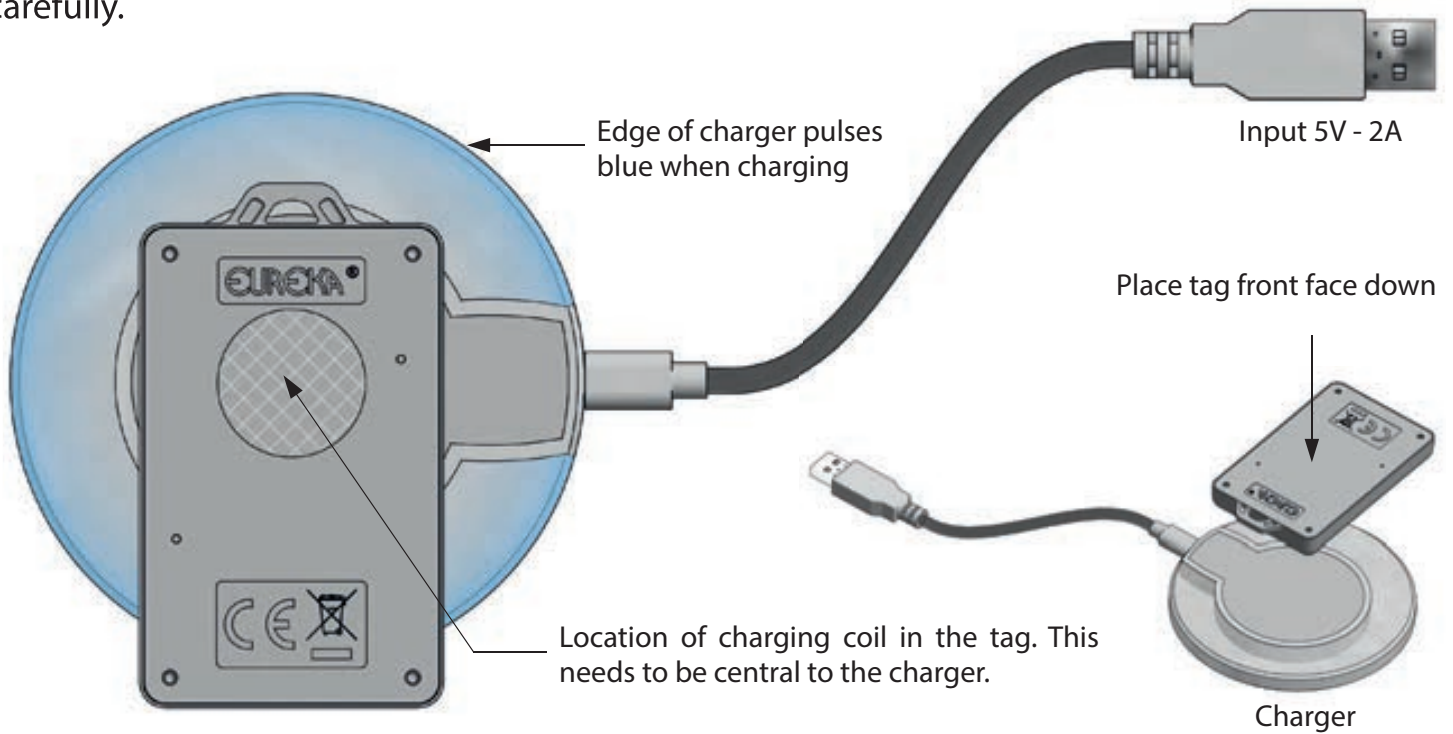

(A14 7122)

To charge the battery, correct placement of the tag on the charger is essential. Please follow these instructions carefully.



1. Connect charger to a 5VDC supply.
2. Place tag, front face down on charger ensuring it is centrally aligned to the location of the charging coil (as shown above).
3. Once the tag is placed in the correct position the charger will start pulsing blue and charging will commence.
4. Charging can take up to 2 hours if the battery is completely flat.
5. The charger will stop pulsing blue when the tag is fully charged.

**Tags will only charge when below 90% capacity.**